

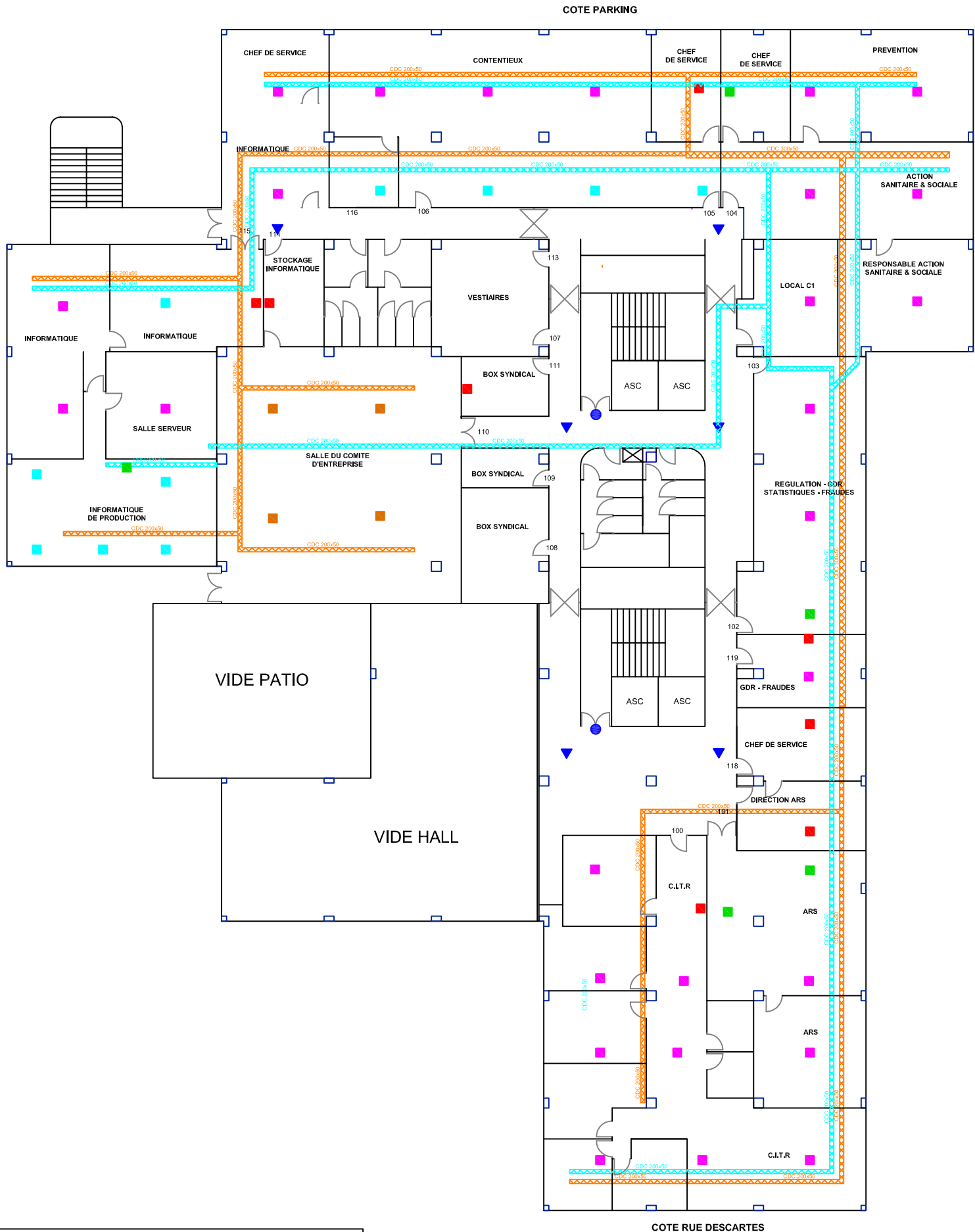



1er Etage



Légende:

- |   |                              |
|---|------------------------------|
| ■ PC (2RJ + 1PCI + 1PCN)                        | ● PTT (1RJ + 1PCI)           |
| ■ PC2 (4RJ + 2PCI + 2PCN)                       | ▼ Pléi (1RJ)                 |
| ■ PC3 (6RJ + 3PCI + 3PCN)                       | ▼ Pléi descente en goulotte  |
| ■ PC4 (8RJ + 4PCI + 4PCN)                       | — Cheminement Courant faible |
| ■ PC5 (10RJ + 5PCI + 5PCN)                      | — Cheminement Courant Fort   |
| ■ PC6 (12RJ + 6PCI + 6PCN)                      |                              |
| ■ PTS (2RJ + 2PCI + 2PCN) descente en goulotte  |                              |
| ■ PTS3 (6RJ + 6PCI + 6PCN) descente en goulotte |                              |

 COMITIS SAS 9E rue de la Sablière 92230 Gennevilliers TELEPHONE : 01 463820419 TELECOPIE : 01 463820519		 7 rue Henri Pescarolo 93370 MONTFERMEIL Tél: 01.43.30.02.28 - Fax: 01.43.30.02.68 Internet: <a href="http://www.bdcim-ing.com">http://www.bdcim-ing.com</a>		CPAM DE LA COTE D'OPALE 35 rue Descartes - 62100 CALAIS		CLIENT : 	
				AFFAIRE 14BD352_CDC_R01		Date : Le 03/04/2015	
				Emetteur : SL		Phase : DOE	
				Format : A3		Indice : 0	